

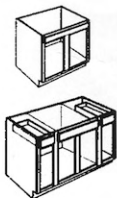

# FLEX CABINETS

A DIVISION OF FLEX MOULDING INC

### SINK BASE CABINETS



FC SB24  
FC SB27  
FC SB30  
FC SB33  
FC SB36  
FC SB39  
FC SB42  
FC SB42L  
FC SB42R  
FC SB48

FC SB54  
FC SB60  
FC SB42L  
FC SB42R

Golden Oak, White, Crystal Maple,  
Madison Cherry and Shaker Maple.  
Please see our price list for complete  
models and availability of finishes.

### VANITY BASE CABINETS

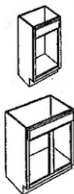

FC-V1816

FC-V2418  
FC-V3018  
FC-V2421  
FC-V3021  
FC-V3621  
FC-VA4821

Golden Oak, White, Crystal Maple,  
Madison Cherry and Shaker Maple.  
Please see our price list for complete  
models and availability of finishes.

### DIAGONAL SINK BASE CABINETS



FC-DSF36

Golden Oak, White, Crystal Maple,  
Madison Cherry and Shaker Maple.  
Please see our price list for complete  
models and availability of finishes.

### VANITY DRAWER BASE CABINETS



FC VDC 3021  
FC VDC 3621  
FC VDC 4221



FB VDC 1221-3  
FB VDC 1521-3

Golden Oak, White, Crystal Maple,  
Madison Cherry and Shaker Maple.  
Please see our price list for complete  
models and availability of finishes.

### VANITY DRAWER BASE CABINETS

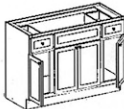

FC VD 3021 L,R FC VD 4821  
FC VD 3621 L,R FC VD 6021  
FC VD 4221 L,R

Golden Oak, White, Crystal Maple,  
Madison Cherry and Shaker Maple.  
Please see our price list for complete  
models and availability of finishes.

### THREE DRAWER BASE CABINETS



FC DB12-3 FC DB21-3  
FC DB15-3 FC DB24-3  
FC DB18-3

Golden Oak, White, Crystal Maple,  
Madison Cherry and Shaker Maple.  
Please see our price list for complete  
models and availability of finishes.

### BASE CABINETS AND PENINSULA CABINETS



FC B9 R-L  
FC B12 R-L  
FC B18 R-L  
FC B21 R-L

FC B24  
FC B27  
FC B30



FC B33 FC PB 18 RL  
FC B36 FC PB24  
FC B39 FC PB30  
FC B42 FC PB36

Golden Oak, White, Crystal Maple,  
Madison Cherry and Shaker Maple.  
Please see our price list for complete  
models and availability of finishes.

### BLIND BASE CABINETS

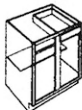

FC BBC30 R-L FC BBC39/42 R-L  
FC BBC36/39 R-L FC BBC42/45 R-L

Golden Oak, White, Crystal Maple,  
Madison Cherry and Shaker Maple.  
Please see our price list for complete  
models and availability of finishes.

### LAZY SUSAN CORNER BASE CABINETS & EASY REACH CORNER BASE CABINETS

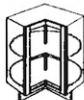

FC LSCB12  
FC BSQC36

Golden Oak, White, Crystal Maple,  
Madison Cherry and Shaker Maple.  
Please see our price list for complete  
models and availability of finishes.

EXTRA MOUNTING INC.  
EXTRA MOUNTING INC.  
EXTRA MOUNTING INC.

Flex Cabinets is a division of Flex Moulding

### WALL CABINETS

42" High 3 shelves  
30" High 2 shelves



FC 930 R-L FC 042 R-L  
FC 1230 R-L FC 1242 R-L  
FC 1830 R-L FC 1542 R-L  
FC 2130 R-L FC 1842 R-L  
FC 2142 R-L



FC 2430 FC 2442  
FC 2730 FC 2742  
FC 3030 FC 3042  
FC 3330 FC 3342  
FC 3630 FC 3642  
FC 3930 FC 3942  
FC 4230 FC 4242

Golden Oak, White, Crystal Maple,  
Madison Cherry and Shaker Maple.  
Please see our price list for complete  
models and availability of finishes.

### BLIND WALL CABINETS

42" High 3 shelves  
30" High 2 shelves

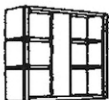

FC-WBC 24/2730 FC-WBC 24/2742  
FC-WBC 27/3030 FC-WBC 27/3042  
FC-WBC 30/3330 FC-WBC 30/3342  
FC-WBC 33/3630 FC-WBC 33/3642

Golden Oak, White, Crystal Maple,  
Madison Cherry and Shaker Maple.  
Please see our price list for complete  
models and availability of finishes.

### DIAGONAL CORNER WALL CABINETS

42" High 3 shelves  
30" High 2 shelves

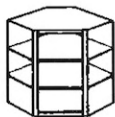

FC-CW2442 GD GLASS DOOR  
FC-CW2430 GD Without Cabinet  
FC-CW2430RS WD FC-WDC2430  
FC-CW2442RS WD Glass Door Only

Golden Oak, White, Crystal Maple,  
Madison Cherry and Shaker Maple.  
Please see our price list for complete  
models and availability of finishes.

### COMBINATION WALL CABINET

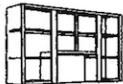

FC W5430  
FC W6030-OPEN

Golden Oak, White, Crystal Maple,  
Madison Cherry and Shaker Maple.  
Please see our price list for complete  
models and availability of finishes.

### 24" HIGH WALL CABINETS

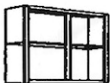

FC 2424  
FC 3024  
FC 3324  
FC 3624

Golden Oak, White, Crystal Maple,  
Madison Cherry and Shaker Maple.  
Please see our price list for complete  
models and availability of finishes.

### 24" DEEP WALL CABINETS

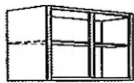

FC WR301524  
FC WR331524  
FC WR361524  
FC WR332424  
FC WR362424  
FC WR302424

Golden Oak, White, Crystal Maple,  
Madison Cherry and Shaker Maple.  
Please see our price list for complete  
models and availability of finishes.

### 12-15-18" HIGH WALL CABINETS

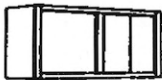

FC W3012 FC 2418 FC 3012  
FC W3312 FC 3018 FC 2415  
FC W3612 FC 3318 FC 3015  
FC 3618 FC 3315  
FC 3615

Golden Oak, White, Crystal Maple,  
Madison Cherry and Shaker Maple.  
Please see our price list for complete  
models and availability of finishes.

### MICROWAVE CABINET



FC MWS3030x12  
FC MWS3042x12

Golden Oak, White, Crystal Maple,  
Madison Cherry and Shaker Maple.  
Please see our price list for complete  
models and availability of finishes.

### MULLION DOOR CABINETS

Wall Glass Door Cabinets

FM W1530GD L,R  
FM W1830GD L,R  
FM W1542GD L,R  
FM W1842GD L,R  
FM W3030GD  
FM W3630GD  
FM W3042GD  
FM W3642GD

Wall Glass Door Only

FM W1530GD L,R  
FM W1830GD L,R  
FM W1542GD L,R  
FM W1842GD L,R

FM WDC2430GD  
FM WDC2442GD  
FM WDC2430GD

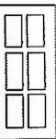

Golden Oak, White, Crystal Maple,  
Madison Cherry and Shaker Maple.  
Please see our price list for complete  
models and availability of finishes.

FLEX MOULDING, INC.

Flex Cabinets is a division of Flex Moulding

## UTILITY CABINETS & OVEN CABINETS



FC WP1584  
FC WP1596  
FC UC1884  
FC UC1896  
FC UC2484  
FC UC2496



FC OVS3084  
FC OVD3084  
FC OVS3096  
FC OVD3096

Golden Oak, White, Crystal Maple, Madison Cherry and Shaker Maple. Please see our price list for complete models and availability of finishes.

## WALL OPEN SHELVES



FC-WS30 -2 Shelves  
FC-WS42 -3 Shelves

Golden Oak, White, Crystal Maple, Madison Cherry and Shaker Maple. Please see our price list for complete models and availability of finishes.

## BASE OPEN SHELVES



FC-BS24 -2 Shelves -RL

Golden Oak, White, Crystal Maple, Madison Cherry and Shaker Maple. Please see our price list for complete models and availability of finishes.

## BASE END CABINETS

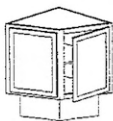

FC BEC24

Golden Oak, White, Crystal Maple, Madison Cherry and Shaker Maple. Please see our price list for complete models and availability of finishes.

## WALL END CABINETS



WEC 1230 R-L  
WEC 1242 R-L

Golden Oak, White, Crystal Maple, Madison Cherry and Shaker Maple. Please see our price list for complete models and availability of finishes.

## WINE RACK & GLASS CABINET

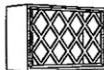

FC WR3018



FC WRG1830

Golden Oak, White, Crystal Maple, Madison Cherry and Shaker Maple. Please see our price list for complete models and availability of finishes.

## ACCESSORIES

FC DWRP1Dish Washer Return Panel 1"  
FC DWRP3Dish Washer Return Panel 3"  
FC DWRP6Dish Washer Return Panel 6"  
FC REP1284Refrigerator End Panel 12" X 84"  
FC REP1296Refrigerator End Panel 12" X 96"  
FC REP2484Refrigerator End Panel 24" X 84"  
FC REP2496Refrigerator End Panel 24" X 96"  
FC WF330Wall Cabinet Filler 3" X 30"  
FC WF342Wall Cabinet Filler 3" X 42"  
FC WF630Wall Cabinet Filler 6" X 30"  
FC WF642Wall Cabinet Filler 6" X 42"  
FC BF630Base Cabinet Filler 6" X 36"  
FC BF636Base Cabinet Filler 6" X 36"  
FC BF636Base Cabinet Filler 6" X 36"  
FC TF384Tall Filler 3" X 84"  
FC TF396Tall Filler 3" X 96"  
FC TF684Tall Filler 6" X 84"  
FC TF696Tall Filler 6" X 96"

FC DWF330Decorated Wall Filler 3" X 30"  
FC DWF342Decorated Wall Filler 3" X 42"  
FC DWF630Decorated Wall Filler 6" X 30"  
FC DWF642Decorated Wall Filler 6" X 42"  
FC DBF336Decorated Base Filler 3" X 36"  
FC DBF636Decorated Base Filler 6" X 36"  
FC FLF330Fluted Filler 3" X 30"  
FC FLF342Fluted Filler 3" X 42"  
FC FLF396Fluted Filler 3" X 96"  
FC GH306Glass Holder 30" W  
FC CRM8 3Crown Moulding 3" Solid Wood  
FC CRM8 4-1/64royal Crown Moulding 4-1/64"

FC DM8Dentil Moulding 1/2"X3/4" Solid Wood  
FC RM8Rope Moulding 3/4" X 96" solid wood  
FC SCM8Scribe Moulding 1-1/2"X3/4" single round  
FC OCM8Outside Corner Moulding 3/4"X3/4" Solid Wood  
FC ICM8Inside Corner Moulding 3/4"X3/4" Solid Wood  
FC QRM8Quarter Round Moulding 3/4"X3/4" Solid Wood  
FC PLY52Plywood 4' X 8' X 1/4"  
FC PLY12Plywood 4' X 8' X 1/2"  
FC PLY34Plywood 4' X 8' X 3/4"  
FC VAL396Valance 3TH X 96" L, wiggie edge  
FC VAL36Valance 36" X 6", wiggie edge  
FC VAL48Valance 48" X 6", wiggie edge  
FC VAL60Valance 60" X 6", wiggie edge  
FC Toe Kick4.5" X 8' X 1/4" Plywood  
FC Sample FrontB12 Sample Front  
FC Sample Doorsample door 12" X 15"

FLEX MOULDING, INC.

Flex Cabinets is a division of Flex Moulding

A white cabinet door with a square top and bottom, featuring a recessed rectangular panel with a double-line border.

### WHITE

#### Features:

Frameless Cabinet.  
Thermofoil door, square top & bottom.  
3/4" melamine plywood box & shelf.  
3/4" drawer sides.  
110° adjustable hinges.

### MAPLE

#### Features:

Solid Door & Fame.  
Raised panel door & Drawer.  
Full overlaid door.  
1/2" Veneer plywood box All sides, top, bottom & interior prefinished.  
Dove Tailed drawer. 100 lbs rated, self closing, under mount full extension drawer slide.  
3/4" plywood shelf.  
110° adjustable hinges.

A maple cabinet door with a raised panel design, featuring a square top and bottom with a recessed rectangular panel.

### CHERRY

#### Features:

Solid Door & Fame.  
Raised panel door & Drawer.  
Full overlaid door.  
1/2" Veneer plywood box All sides, top, bottom & interior prefinished.  
Dove Tailed drawer. 100 lbs rated, self closing, under mount full extension drawer slide.  
3/4" plywood shelf.  
110° adjustable hinges.

A cherry cabinet door with a raised panel design, featuring a square top and bottom with a recessed rectangular panel.

### SHAKER

#### Features:

Shaker finish over maple  
Solid Door & Fame.  
Raised panel door & Drawer.  
Full overlaid door.  
1/2" Veneer plywood box All sides, top, bottom & interior prefinished.  
Dove Tailed drawer. 100 lbs rated, self closing, under mount full extension drawer slide.  
3/4" plywood shelf.  
110° adjustable hinges.

A shaker cabinet door with a raised panel design, featuring a square top and bottom with a recessed rectangular panel.

### OAK

#### Features:

Veneer Door & Solid Fame.  
Arch wall door, square bottom.  
1/2" Veneer plywood box All sides, bottom & interior prefinished.  
Half overlaid door.  
3/4" drawer sides.  
3/4" plywood shelf.  
110° adjustable hinges.

An oak cabinet door with a raised panel design, featuring a square top and bottom with a recessed rectangular panel.

### PECAN

#### Features:

Maple with a pecan finish  
Solid Door & Fame.  
Raised panel door & Drawer.  
Full overlaid door.  
1/2" Veneer plywood box All sides, top, bottom & interior prefinished.  
Dove Tailed drawer. 100 lbs rated, self closing, under mount full extension drawer slide.  
3/4" plywood shelf.  
110° adjustable hinges.

A pecan cabinet door with a raised panel design, featuring a square top and bottom with a recessed rectangular panel.



Dove Tailed  
Drawer Boxes  
Featured On Our  
Maple, Cherry  
& Pecan Models

---

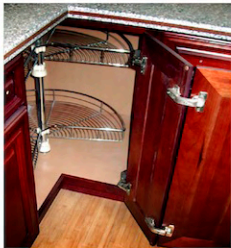

Self Closing  
Under Mount  
Drawer Slides  
Are Featured In  
Our Maple,  
Cherry, Pecan &  
Common Box  
Models

---



White Thermfoil  
Cabinets Feature  
3/4" Drawer Sides  
& Melamine  
Plywood Boxes  
& Shelves

---



Lazy Susans  
Are Featured In  
Our Lazy Susan  
Corner Base  
Cabinets.

---



Adjustable Hinges,  
in Some Cabinets  
Soft Closing  
Hinges Are  
Available

---





AVAILABLE SOON



AVAILABLE SOON

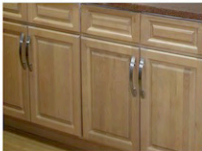

AVAILABLE SOON

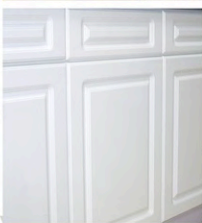
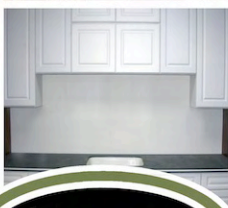

**FLEX CABINETS**  
A DIVISION OF FLEX MOULDING INC